

88221100 & 88222100
QUICK DISCONNECT CONTACTS

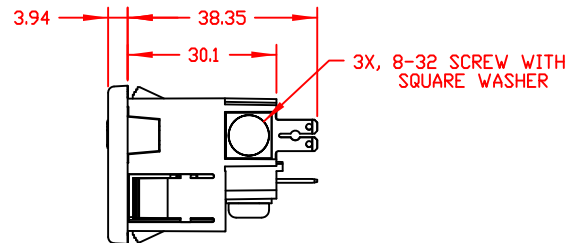

88221100

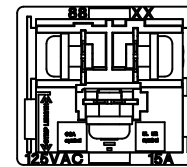

88221100

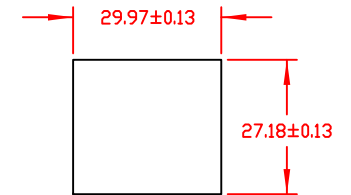

PANEL CUTOUT

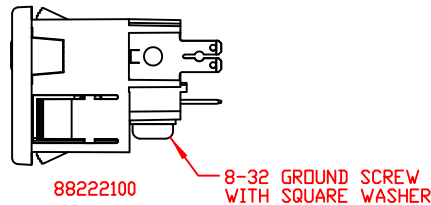

88222100

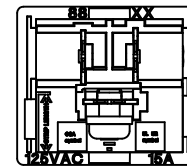

88222100

NOTES:
1. PANEL THICKNESS RANGE .81mm TO 2.0mm (.032" TO .079"), THIS INCLUDES ANY FINISH, SUCH AS POWDER COAT.

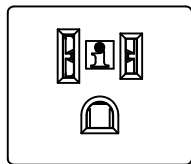

88223100 & 88224100
SOLDER TAB CONTACTS

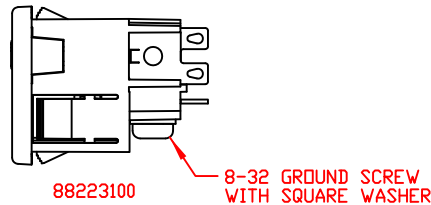

88223100

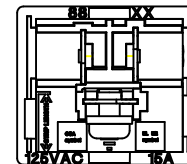

88223100

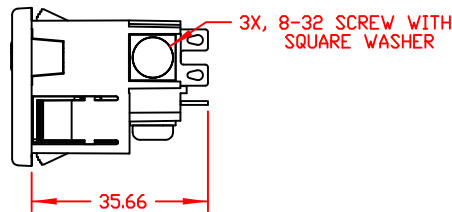

88224100

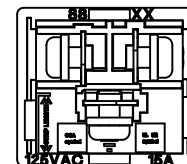

88224100

THIS DOCUMENT AND ITS CONTENTS ARE THE PROPRIETARY, CONFIDENTIAL PROPERTY OF INTERPOWER CORPORATION. NO USE OR COPIES MAY BE MADE WITHOUT WRITTEN PERMISSION FROM INTERPOWER.

DIMENSIONS IN: MM

TITLE BLACK NEMA 5-15 SNAP-IN ASSEMBLIES

DRAFT BY: BEM DATE: 9-30-13

PART NUMBER: 88221100, 88222100, 88223100, 88224100

DRAFTING APPROVAL: SRK DATE: 9-30-13

MATERIAL:

DO NOT SCALE

SHEET 1 OF 1

INTERPOWER CORPORATION

1	6	INITIAL RELEASE	10/07/13	DDF
2D	3D	CHANGE DESCRIPTION	DATE	BY
REV				