

To Insert and Remove Connector

(For use only with molded IEC 60320 plug connectors & connectors)

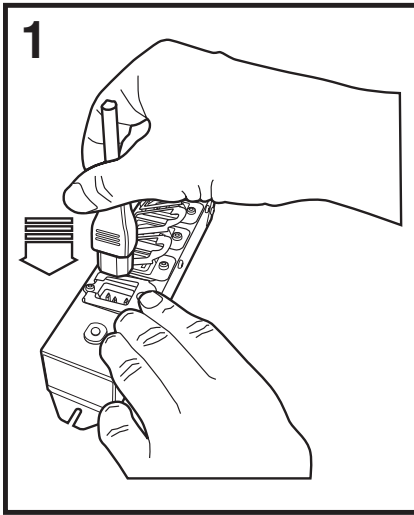

1
Depress the thumb tab and fully insert the connector into the inlet or outlet.

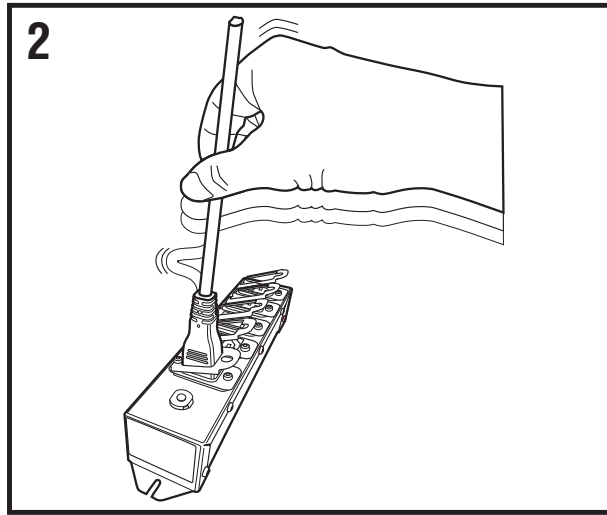

2
Release the thumb tab which will automatically engage the lock, holding the connector in place.

Note: For MAXIMUM retention capability, lift thumb tab while securing the connector in the fully inserted position.

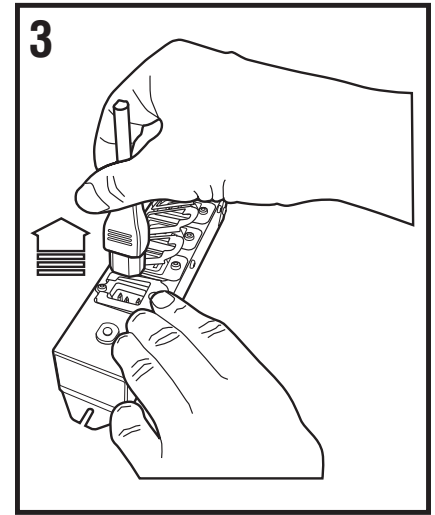

3
To remove the connector, depress the thumb tab and hold down while extracting the connector from the inlet or outlet.

Do's and Don'ts

Interpower® connector locks are manufactured to hold Interpower connectors firmly in place. They may also work with products from other companies. If needed, for connectors with a larger C13 body, it is suggested to use Interpower connector lock P/N 85910510; for connectors with a smaller Sheet E plug connector body, it is suggested to use Interpower connector lock P/N 85910500.

Note: If using angled connectors, APS units are available from Interpower with the locks in the proper direction for your connectors.

Correct

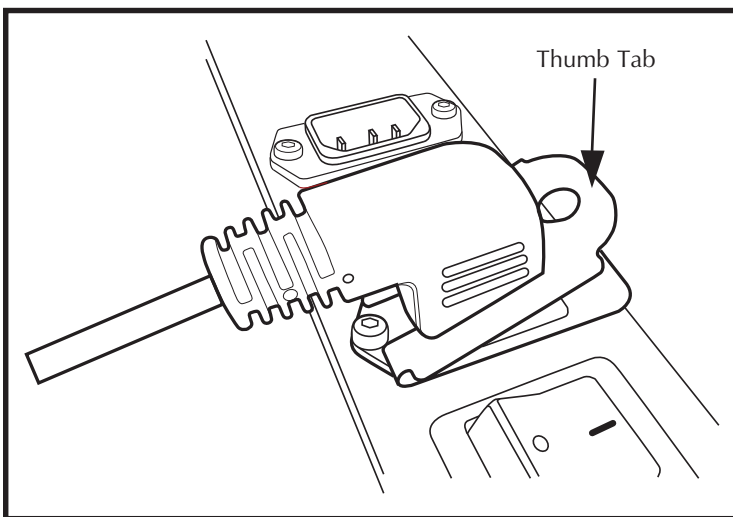

Incorrect

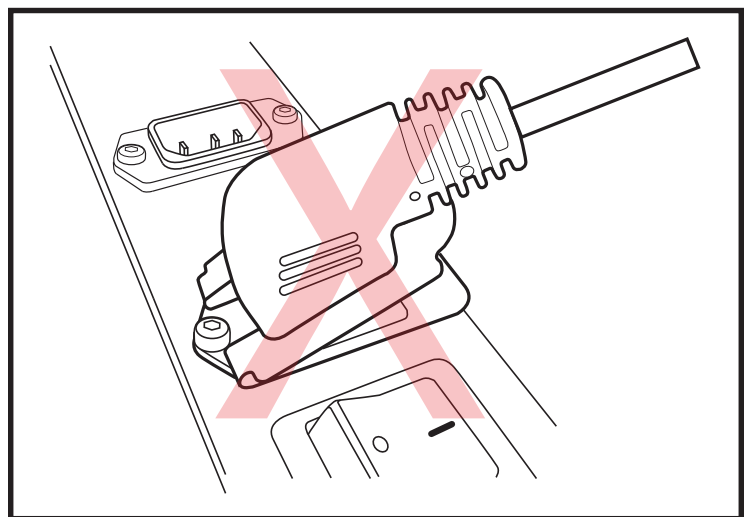

Rev. 05-23



U.S.A.
P.O. Box 115, Oskaloosa, IA 52577
United States/Canada, Puerto Rico, Virgin Islands
Toll-Free Phone: (800) 662-2290 • Toll-Free Fax: (800) 645-5360
International
Phone: (641) 673-5000 • Fax: (641) 673-5100
E-mail: sales@interpower.com

UK
10 Kelvin Drive • Knowlhill, Milton Keynes
Buckinghamshire MK5 8NH
UK, Ireland, Germany, Switzerland, Austria
Freephone: 00800 5566 5566 • Freefax: 00800 5655 5655
International
Phone: +44 (0)1908 295300 • Fax: +44 (0)1908 295301
E-mail: uk@interpower.com