

Cut-out for mounting switch on surface

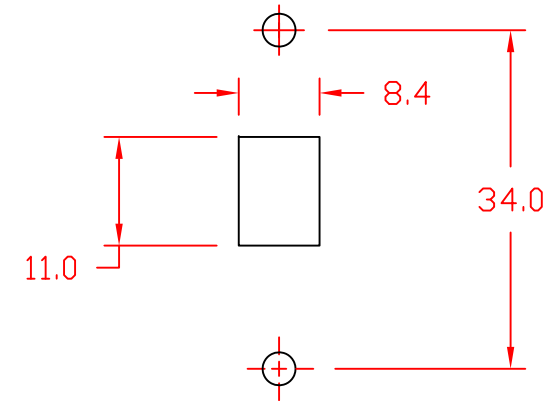

Cutout for mounting switch behind panel

Wiring & Components:  
 - - - User Supplied  
 - - - User Supplied (230V circuit 2:1 mode)  
 - - - User Supplied (115V circuit 1:1 mode)

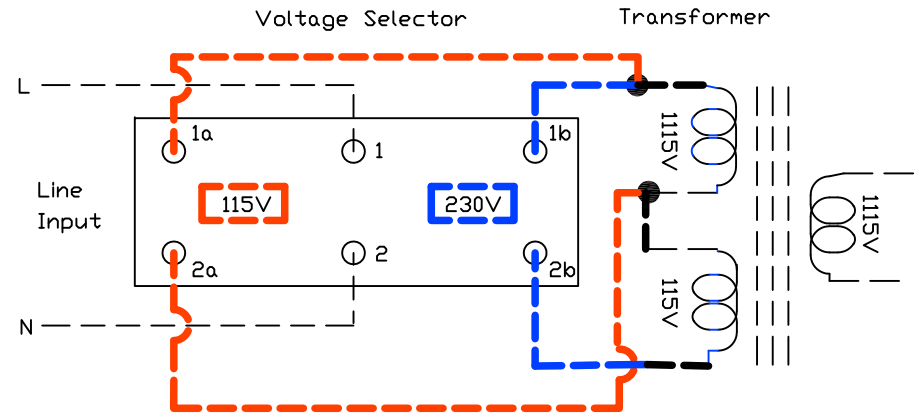

THIS DOCUMENT AND ITS CONTENTS ARE THE PROPRIETARY CONFIDENTIAL PROPERTY OF INTERPOWER CORPORATION. NO USE OR COPIES MAY BE MADE WITHOUT WRITTEN PERMISSION FROM INTERPOWER CORPORATION.

DIMENSIONS IN MILLIMETERS

TITLE Voltage Selector Switch

DRAFT BY: DDF DATE: 6/20/06

PART NUMBER: 83710030

DRAFTING APPROVAL: DATE:

MATERIAL:

DD NOT SCALE

INTERPOWER CORPORATION

DATE

INITIALS

SHEET 1 OF 1

REV	CHANGE DESCRIPTION	DATE	INITIALS
C	Corrected & simplified schematic labelling/wiring.	9/13/17	DDF
B	Added cutouts and dimensions for mounting.	7/10/09	DDF
A	Inserted wiring diagram/schematic.	6/20/06	DDF