

FRONT VIEW

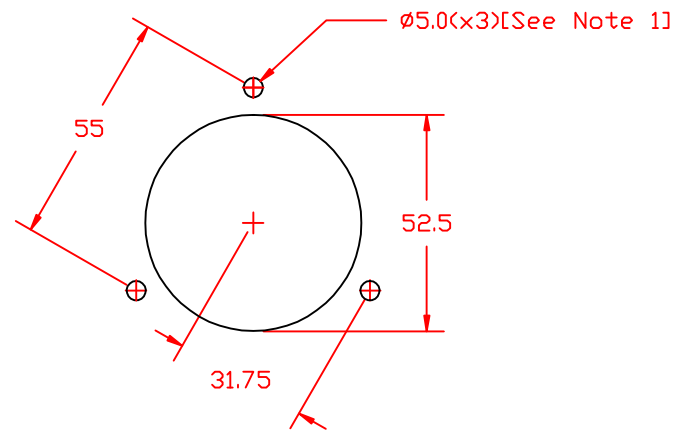

CUTOUT

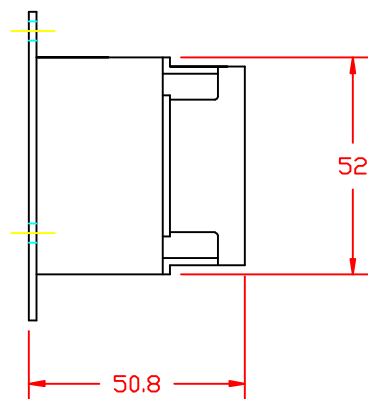

SIDE VIEW

Note 1: Recommended diameter for thru-hole (screw/nut combination) hardware mounting method. Other methods will require holes with different dimensions and parameters.

THIS DOCUMENT AND ITS CONTENTS ARE THE PROPRIETARY CONFIDENTIAL PROPERTY OF INTERPOWER CORPORATION. NO USE OR COPIES MAY BE MADE WITHOUT WRITTEN PERMISSION FROM INTERPOWER CORPORATION.

DIMENSIONS IN MILLIMETERS

TITLE NEMA L6-20
Flanged Inlet

PART NUMBER: 88030090

INTERPOWER CORPORATION

DRAFT BY: JPC DATE: 6-21-04

DRAFTING APPROVAL: JPC DATE: 6-21-04

MATERIAL:

DO NOT SCALE

SHEET 1 OF 1

REV	CHANGE DESCRIPTION	DATE	INITIALS
B	Added dimension information to cutout screw holes and Note 1.	3/26/12	DDF
A	Corrected wrong dimension (31 to 31.75).	5/22/08	DDF