

FRONT VIEW

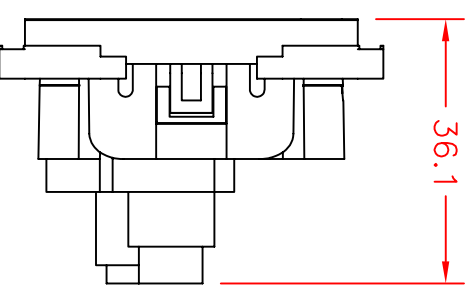

SIDE VIEW

Note 1: Recommended diameter for thru-hole (screw/nut combination) hardware mounting method. Other methods will require holes with different dimensions and parameters.

THIS DOCUMENT AND ITS CONTENTS ARE THE PROPRIETARY CONFIDENTIAL PROPERTY OF INTERPOWER CORPORATION. NO USE OR COPIES MAY BE MADE WITHOUT WRITTEN PERMISSION FROM INTERPOWER CORPORATION.

DIMENSIONS IN MILLIMETERS		TITLE	
DRAFT BY:	ATS/DEG	DATE:	05/29/19
DRAFTING APPROVAL:	DDF	DATE:	05/31/19
MATERIAL:	-	SCALE:	FULL SCALE
INITIALS	DDF	DATE	5/31/19
INTRODUCTION OF PART:	INTERPOWER CORPORATION		
CHANGE DESCRIPTION	SHEET 1 OF 1		

CHINESE COMBINATION CLASS I & CLASS II SOCKET, 10A

PART NUMBER: 88052181